

# Compact Linear Actuators Accessories (Sold separately)

Overview,  
Product  
Series

FLEX  
Compatible  
Products

Motorized  
Linear  
Slides

**αSTEP**  
EZSII

**αSTEP**  
EZSII  
Cleanroom

Motorized  
Cylinders

**αSTEP**  
EZCII

Motorizes  
Linear  
Slides/  
Cylinders

Common  
Controllers

Accessories

Compact  
Linear  
Actuators

**DRL**

Accessories

Hollow  
Rotary  
Actuators

**DGI**

Accessories

## Mounting Plates (RoHS)

These are dedicated mounting brackets used for installing the actuator.  
Each mounting plate comes with mounting screws for installing the actuator to the plate.

● Please furnish the mounting screws for installing the mounting plate to the equipment.

Material: Iron  
Surface Treatment: Electroless nickel plating



### Product Line

Product Name	Applicable Product	Mass (g)
<b>PADRL-20</b>	<b>DRL20</b>	25
<b>PADRL-28</b>	<b>DRL28</b>	45
<b>PADRL-42</b>	<b>DRL42</b>	165
<b>PADRL-60</b>	<b>DRL60</b>	570

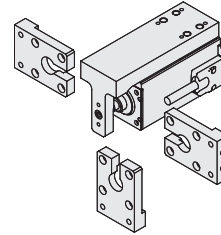

The actuator can be installed from one of three directions according to your equipment.  
(The **PADRL-20** can be installed only from the bottom.)

### Dimensions (Unit mm)

#### PADRL-20

CAD D528

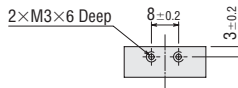
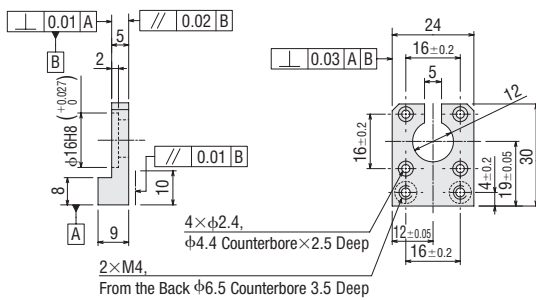

#### PADRL-28

CAD D465

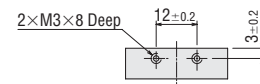
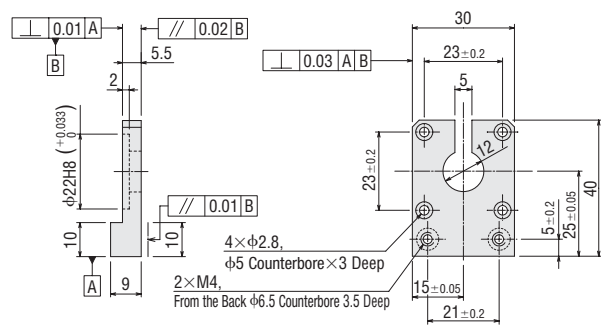

#### PADRL-42

CAD D466

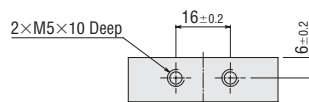
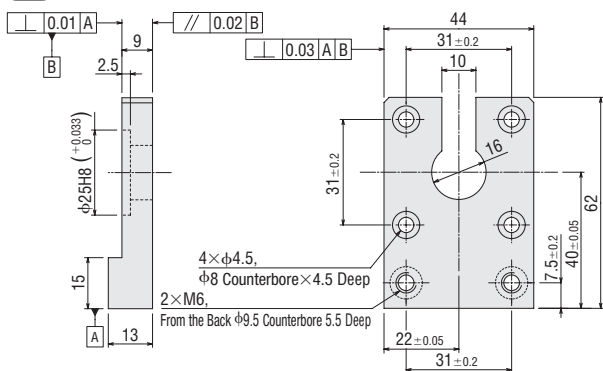

#### PADRL-60

CAD D2751

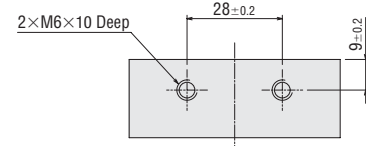
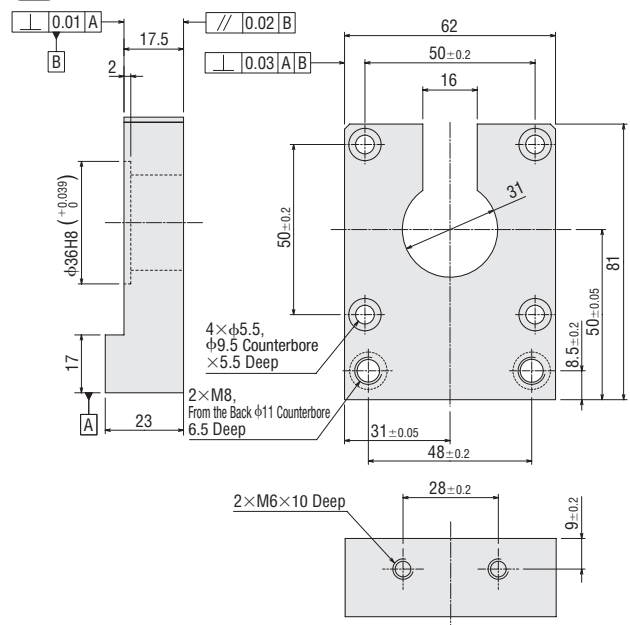

## Connection Cables (RoHS)

These lead wires with connector are convenient for connecting connector-coupled actuators. They eliminate the need for assembling the lead wire and connector. (Connection cable (0.6 m) is included with the **DRL20**.)

### Product Line

Product Name	Applicable Product	Length (m)	Conductor AWG
<b>LC5N06A</b>	<b>DRL20</b>	0.6	24
<b>LC5N10A</b>		1	(0.2 mm <sup>2</sup> )



## Motor Connector Set (RoHS)

This is a set of connector housings and contacts for use with connector-coupled motors. Each package contains enough housings and contacts for 30 actuators.

### Product Line

Product Name	Applicable Product
<b>CS5N30A</b>	<b>DRL20</b>

### Specifications

Connector Housing	Contact	Applicable Crimp Tool	Manufacturer	Applicable Cable
51065-0500	50212-8100	57176-5000	MOLEX	AWG30~24 (0.05~0.2 mm <sup>2</sup> ) Outer Sheath Diameter $\phi$ 1.4 mm or less Strip length is 1.3~1.8 mm



#### Note

● The crimp tool is not included. Please provide separately.

## Connection Cable Set (RoHS)

The cables are for connecting the driver with the actuator, controller and DC power supply. The set includes three cables (for actuator, power supply and I/O signal). One end of the lead wire is crimped with a connector, therefore crimping is not necessary.

### Product Line

Product Name	Length (m)	Conductor AWG
<b>LCS04SD5</b>	0.6	22 (0.3 mm <sup>2</sup> )



## DIN Rail Mounting Bracket (RoHS)

It is possible with a single fixing screw to install the installation brackets to the DIN rail, disassemble it from the DIN rail, and adjust the position of it. As screws for fixing the driver are included, there is no need to prepare spacers or screws separately.

### Product Line

Product Name
<b>MADP01S1</b>

